

THESE PLANS ARE NOT TO BE USED FOR BID OR CONSTRUCTION

PLANS ARE FINAL FOR SANITARY SEWER AND WATER MAIN DESIGN

18 A

PRELIMINARY AND FINAL MAJOR SUBDIVISION & PRELIMINARY AND FINAL SITE PLAN
TAX MAP SHEET 166 DATED 12/1987, REV 04-10-01 AND SHEET 174 DATED 12/1987, REV 6-12-2003
EL at MARLBORO 79, LLC - MARLBORO PARKE
TRUCK TURNING RADIUS PLAN
BLOCK 415, LOT 22
TOWNSHIP OF MARLBORO, MONMOUTH COUNTY, NEW JERSEY

Bowman Consulting Group, Ltd.
303 W. Main Street
Freehold, New Jersey 07728
www.bowmanconsulting.com
E-mail: NJ@BowmanConsulting.com
Phone: 732-686-6800
Fax: 732-686-6801
NJ Certificate of Authorization
No. 246A-28222000
Sean A. Delany
SEAN A. DELANY, N.J. Professional Engineer, Lic. 24GE0447100

Bowman CONSULTING

PROJ: 080728-F1-003
DATE: 01.17.2020
CHKD: SAD
THIS DRAWING AND ALL INFORMATION CONTAINED HEREIN IS AUTHORIZED FOR USE ONLY BY THE PARTY FOR WHOM THE WORK WAS CONTRACTED OR TO WHOM IT IS CERTIFIED. THIS DRAWING MAY BE COPIED, REPRODUCED, DISCLOSED, DISTRIBUTED OR REPRODUCED FOR ANY OTHER PURPOSE WITHOUT THE WRITTEN CONSENT OF BOWMAN CONSULTING GROUP, LTD. ALL RIGHTS RESERVED.

6					
5					
4					
3					
2					
1	REVISIONS AS PER MARCH 6, 2020 CME REVIEW LETTER	4/20/20			
	REVISION	DATE	CHKD		

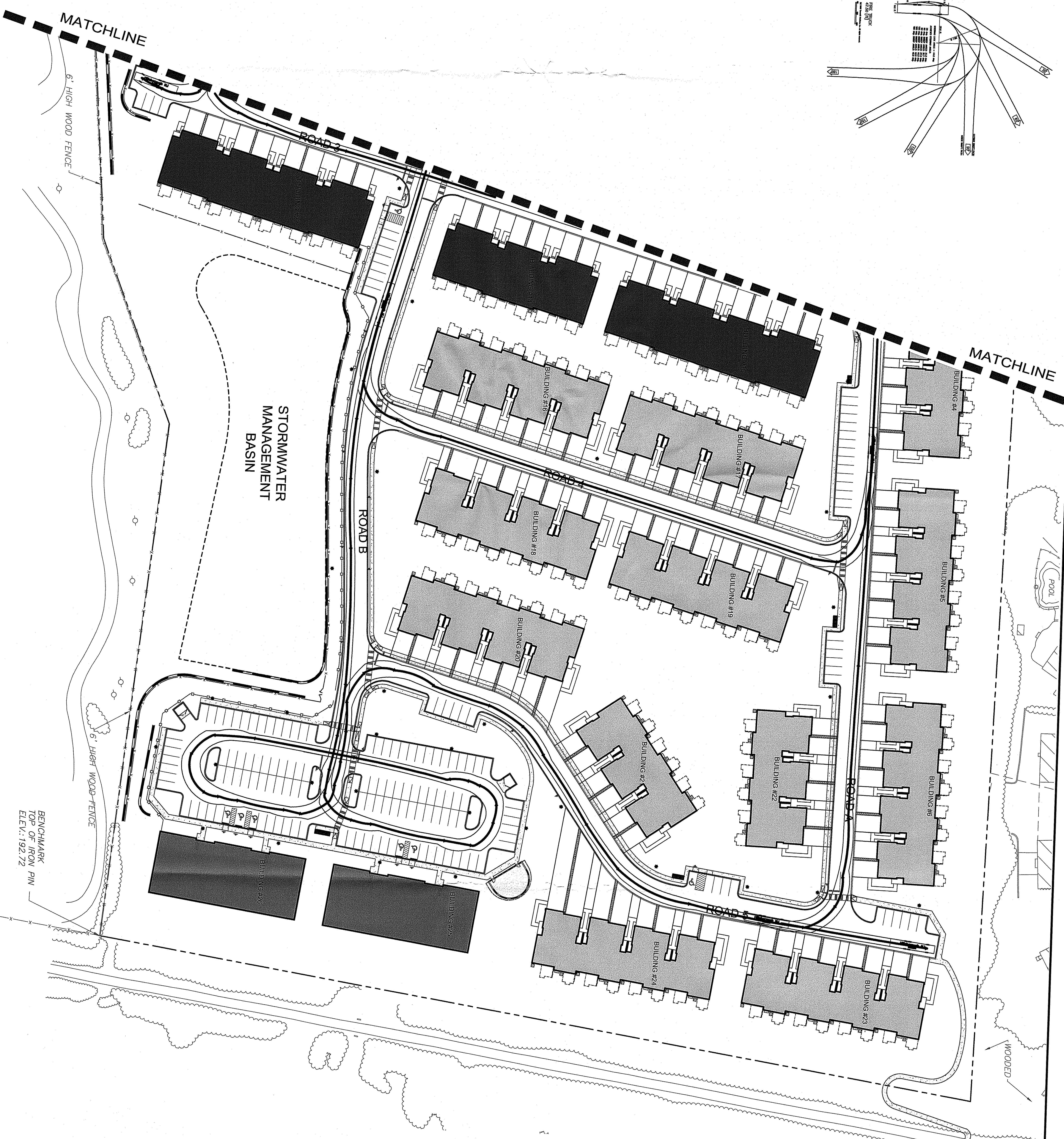
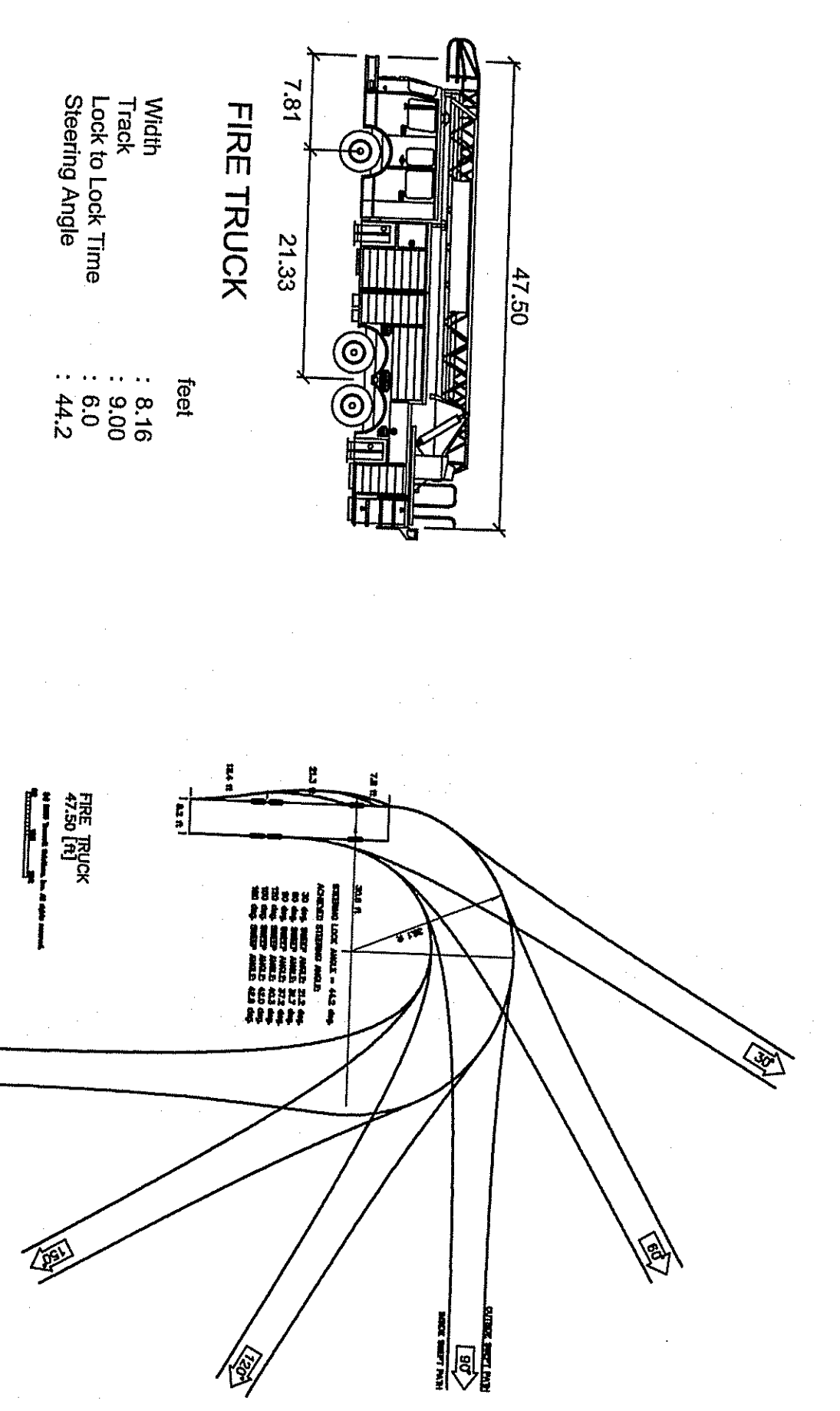

THESE PLANS ARE

PLANS ARE FINAL FOR SANITARY SEWER AND WATER MAIN DESIGN

PRELIMINARY AND FINAL MAJOR SUBDIVISION & PRELIMINARY AND FINAL SITE PLAN
 TAX MAP SHEET 166 DATED 12/1987, REV 04-10-01 AND SHEET 174 DATED 12/1987, REV 5-12-2003
EL at MARLBORO 79, LLC - MARLBORO PARKE
TRUCK TURNING RADIUS PLAN
 BLOCK 415, LOT 22
 TOWNSHIP OF MARLBORO, MONMOUTH COUNTY, NEW JERSEY

Bowman Consulting Group, Ltd.
 303 W. Main Street
 Freehold, New Jersey 07728
 www.bowmanconsulting.com
 E-mail: NJ@BowmanConsulting.com
 Phone: 732-465-5500
 FAX: 732-465-5501
 NJ Certificate of Authorization
 No. 24GA2822800
Sean A. Delany
 SEAN A. DELANY, N.J. Professional Engineer, Lic. 24GE04447100



PROJ: 080728-F1-003
 DATE: 01.17.2020
 CHKD: SAD
 THIS DRAWING AND ALL INFORMATION CONTAINED HEREIN IS AUTHORIZED FOR USE ONLY BY THE PARTY FOR WHOM THE WORK WAS CONTRACTED OR TO WHOM IT IS OTHERWISE SO RELEASED. IT IS NOT TO BE COPIED, REPRODUCED, OR TRANSMITTED IN ANY FORM OR BY ANY MEANS, WITHOUT THE WRITTEN CONSENT OF BOWMAN CONSULTING GROUP, LTD. ALL RIGHTS RESERVED.

6									
5									
4									
3									
2									
1	REVISIONS AS PER MARCH 6, 2020 CME REVIEW LETTER	4/20/20							
	REVISION	DATE	CHKD						