

EXISTING		PROPOSED	
	BOUNDARY LINE		BOUNDARY LINE
	CONTOUR LINE		CONTOUR LINE
	SPOT ELEVATION		SPOT ELEVATION
	BUILDING		BUILDING
	WALL		WALL
	WATER		WATER
	NARROW		NARROW
	STREAM		STREAM
	SANITARY MAIN		SANITARY MAIN
	SANITARY LATERAL		SANITARY LATERAL
	OVERHEAD WIRE		OVERHEAD WIRE
	ELECTRIC		ELECTRIC
	TELEPHONE		TELEPHONE
	UTILITY POLE		UTILITY POLE
	HYDRANT		HYDRANT
	MANHOLE		MANHOLE
	FENCE		FENCE
	LIGHT FIXTURE		LIGHT FIXTURE
	TEST PIT LOCATION		TEST PIT LOCATION
	GRADE LOCATION		GRADE LOCATION
	SHEET CENTER LINE		SHEET CENTER LINE

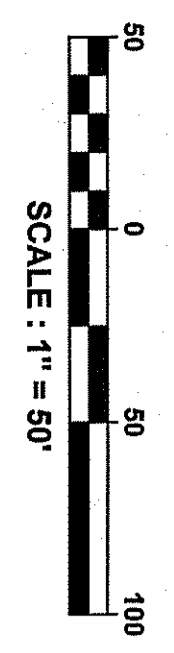

Line #	Length	Direction
L1	36.63'	S85° 23' 13\"
L2	24.17'	N65° 08' 14\"
L3	43.82'	S78° 28' 53\"
L4	46.86'	S85° 09' 31\"
L5	29.32'	S87° 19' 29\"
L6	15.24'	S79° 03' 50\"
L7	14.93'	S78° 30' 21\"
L8	23.22'	S83° 16' 03\"
L9	24.12'	N64° 03' 51\"
L10	24.07'	N63° 54' 02\"
L11	20.20'	N63° 54' 02\"
L12	20.25'	N67° 29' 13\"
L13	29.25'	S76° 59' 27\"
L14	62.56'	N83° 27' 10\"
L15	11.42'	S85° 28' 03\"
L16	48.24'	S86° 07' 30\"
L17	52.27'	N88° 54' 31\"
L18	64.12'	S83° 40' 59\"
L19	32.14'	S70° 30' 43\"
L20	32.14'	S70° 30' 43\"
L21	30.84'	S89° 46' 09\"
L22	84.15'	S1° 42' 04\"
L23	11.44'	S46° 34' 22\"
L24	35.27'	S77° 24' 10\"
L25	28.68'	N22° 43' 48\"
L26	41.32'	S82° 36' 32\"
L27	17.12'	N6° 52' 50\"
L28	47.18'	N63° 40' 44\"
L29	46.20'	N48° 13' 18\"
L30	68.48'	N13° 28' 54\"
L31	68.18'	N48° 32' 18\"
L32	58.85'	S89° 48' 05\"
L33	40.48'	S43° 18' 10\"
L34	42.31'	S° 32' 44\"
L35	18.13'	N1° 35' 18\"
L36	25.25'	N28° 34' 57\"
L37	63.33'	N20° 07' 26\"
L38	33.98'	N28° 11' 16\"
L39	27.04'	N45° 25' 32\"
L40	28.88'	N13° 21' 21\"
L41	80.87'	N28° 48' 52\"
L42	37.10'	N28° 07' 48\"
L43	75.32'	N13° 38' 42\"
L44	52.18'	N10° 07' 42\"
L45	20.34'	N44° 08' 27\"
L46	43.88'	N27° 04' 35\"
L47	33.81'	N83° 57' 18\"
L48	35.31'	S52° 25' 52\"
L49	88.17'	S27° 54' 40\"
L50	48.04'	S46° 10' 18\"
L51	62.31'	S38° 03' 07\"
L52	44.89'	N44° 21' 13\"
L53	68.00'	N67° 32' 33\"
L54	71.85'	N67° 30' 54\"
L55	36.20'	S38° 04' 17\"
L56	45.77'	S31° 53' 40\"
L57	33.92'	N13° 34' 04\"
L58	50.81'	N33° 03' 48\"
L59	20.40'	N42° 27' 22\"
L60	47.31'	S22° 58' 53\"
L61	44.54'	S59° 48' 07\"
L62	46.92'	S89° 20' 12\"
L63	44.09'	S72° 30' 12\"
L64	58.14'	N87° 48' 11\"
L65	32.45'	N° 16' 57\"
L66	37.15'	N28° 19' 18\"
L67	18.12'	N47° 27' 02\"
L68	33.41'	S39° 57' 07\"
L69	42.84'	N41° 57' 47\"
L70	18.44'	N48° 31' 38\"
L71	17.75'	S38° 14' 28\"
L72	31.37'	N5° 21' 33\"



<b>PROJECT INFORMATION</b> BLOCK 171 LOT 79 TOWNSHIP OF ARDSLEY PLAZA HARRISON TOWNSHIP, NJ CLARK, NJ 07088		<b>CLIENT</b> STELLA ESTATES 107 WILLIAM STREET CLARK, NJ 07088		<b>DESIGNER</b> DAVID & STACEY HERMANDEZ 2350 ROUTE 916, SECOND FLOOR CLARK, NJ 07088		<b>APPLICANT'S PROFESSIONALS</b> GET PARTNERSHIP LLC 2350 ROUTE 916, SECOND FLOOR CLARK, NJ 07088 ENVIRONMENTAL MARSHALL ALTYMUS 107 WILLIAM STREET CLARK, NJ 07088 SURVEYOR SURVEYOR'S LLC 1888 ROUTE 54, SUITE 1A WALL, NJ 07719 GEOTECHNICAL ENGINEER 61 MAIN STREET SPYGLASS, NJ 08872	
<b>REVISIONS</b> NO. DATE BY 1 02/25/20 PATRICK R. WILSON, LLC		<b>APPROVED BY</b> FOR CONSTRUCTION: _____ PLAN INFORMATION: _____		<b>EXISTING CONDITIONS</b> PLAN 1 of 4		<b>INSITE ENGINEERING, LLC</b> 100 WEST 10TH STREET SUITE 200 NEWARK, NJ 07102 TEL: 973-261-1111 WWW.INSITEENGINEERING.COM	



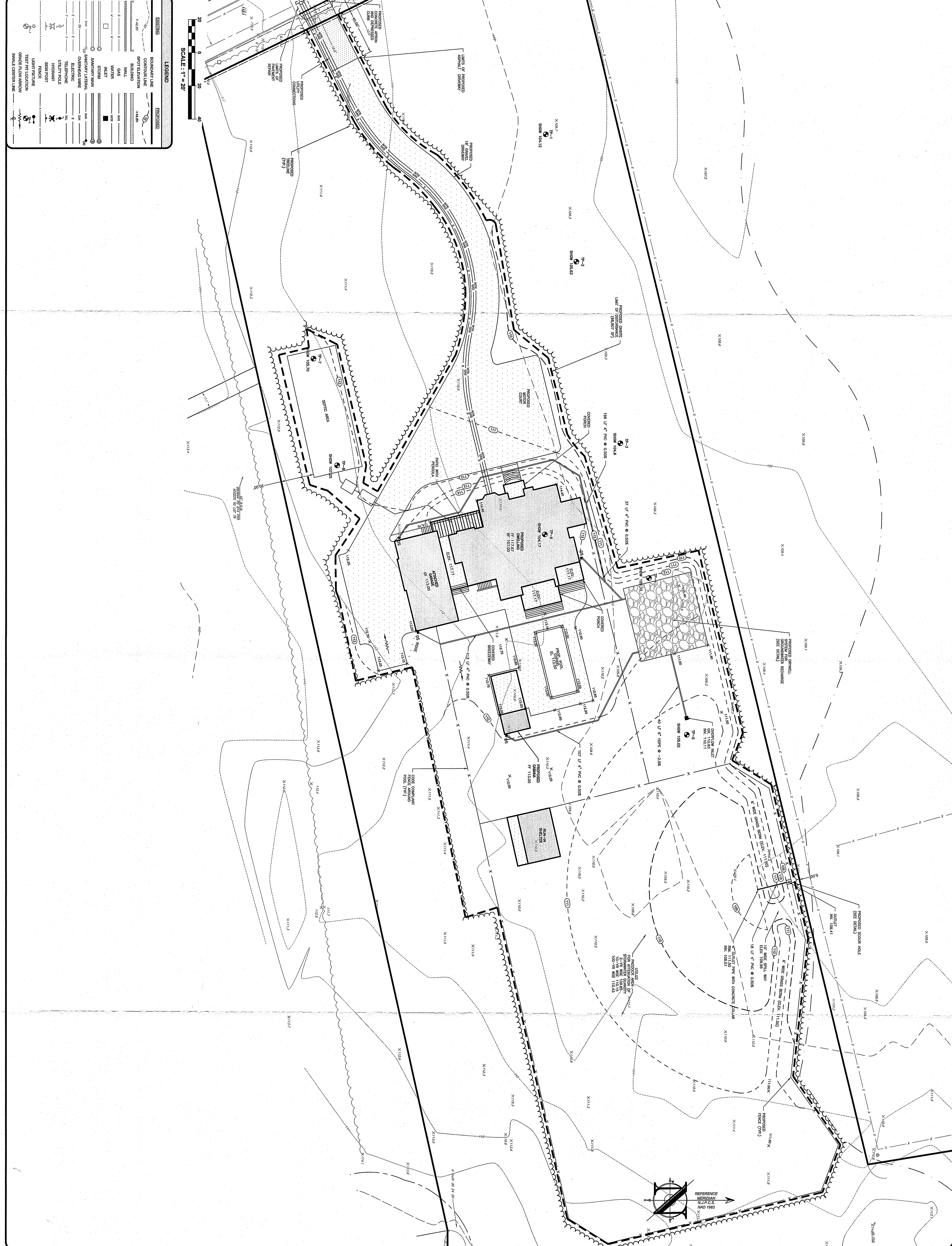

**LEGEND**

EXISTING	PROPOSED
BOUNDARY LINE	BOUNDARY LINE
CONTOUR LINE	CONTOUR LINE
SLOPE	SLOPE
GRADING	GRADING
BUILDING	BUILDING
PAVING	PAVING
WATER	WATER
SEWER	SEWER
STORM	STORM
SANITARY MAIN	SANITARY MAIN
SANITARY LATERAL	SANITARY LATERAL
OVERHEAD WIRE	OVERHEAD WIRE
UNDERGROUND WIRE	UNDERGROUND WIRE
UTILITY POLE	UTILITY POLE
UTILITY POLE	UTILITY POLE
INHOUSING	INHOUSING
SEWER POST	SEWER POST
SEWER	SEWER
SEWER	SEWER
TEST PIT LOCATION	TEST PIT LOCATION
GRAVEL FILL AREA	GRAVEL FILL AREA
SMALL CONTAINMENT	SMALL CONTAINMENT

SCALE: 1" = 20'

**REVISIONS**

NO.	DATE	DESCRIPTION
1	08/27/20	PERFORM GRADING PLAN
2	08/27/20	REVISIONS TO PERFORM GRADING PLAN
3	08/27/20	REVISIONS TO PERFORM GRADING PLAN
4	08/27/20	REVISIONS TO PERFORM GRADING PLAN
5	08/27/20	REVISIONS TO PERFORM GRADING PLAN
6	08/27/20	REVISIONS TO PERFORM GRADING PLAN
7	08/27/20	REVISIONS TO PERFORM GRADING PLAN
8	08/27/20	REVISIONS TO PERFORM GRADING PLAN
9	08/27/20	REVISIONS TO PERFORM GRADING PLAN
10	08/27/20	REVISIONS TO PERFORM GRADING PLAN

**NOT FOR CONSTRUCTION**

APPROVED BY: \_\_\_\_\_

**PLAN INFORMATION**

PROJECT NO: 20-1384-01-1 - PLOT

DATE: 08/27/20

SCALE: AS SHOWN

DESIGNED BY: FWV

CHECKED BY: FWV

**PLOT PLAN**

GRADING PLAN

3 of 4

**INSITE ENGINEERING, LLC**

REGISTERED PROFESSIONAL ENGINEERS

CERTIFICATE NO. 2371

EXPIRES 12/31/2023

4000 ROUTE 34, SUITE 2A, WALL, NJ 07719

908-861-9100

www.insiteeng.com

PROJECT NO: 20-1384-01-1 - PLOT

DATE: 08/27/20

SCALE: AS SHOWN

DESIGNED BY: FWV

CHECKED BY: FWV

**PROJECT INFORMATION**

**HERNANDEZ RESIDENCE**

CLIENT: DAVID & STACEY HERNANDEZ

ADDRESS: 2800 ROUTE 294, SECOND FLOOR, OLD BRIDGE, NJ 08857

ARCHITECT: CASATI ARCHITECTS, LLC

50 LANTANA ROAD, SECOND FLOOR, NEW BRUNSWICK, NJ 08901

ENVIRONMENTAL: ENVIRONMENTAL CONSULTANTS, LLC

1400 ROUTE 1, SUITE 1A, WALL, NJ 07719

DESIGNER: IN-SITE ENGINEERING, LLC

4000 ROUTE 34, SUITE 2A, WALL, NJ 07719

REGISTERED PROFESSIONAL ENGINEERS

GEOTECHNICAL ENGINEERS: GEOTECHNICAL ENGINEERS & ASSOCIATES

100 CANTON ROAD, SUITE 100, WALL, NJ 07719

REGISTERED PROFESSIONAL ENGINEERS

**APPLICANTS PROFESSIONALS**

**DAVID & STACEY HERNANDEZ**

2800 ROUTE 294, SECOND FLOOR, OLD BRIDGE, NJ 08857

**STELLA ESTAIRES**

100 CANTON ROAD, SUITE 100, WALL, NJ 07719

**REGISTERED PROFESSIONALS**

**DAVID & STACEY HERNANDEZ**

2800 ROUTE 294, SECOND FLOOR, OLD BRIDGE, NJ 08857

**STELLA ESTAIRES**

100 CANTON ROAD, SUITE 100, WALL, NJ 07719

**REGISTERED PROFESSIONALS**

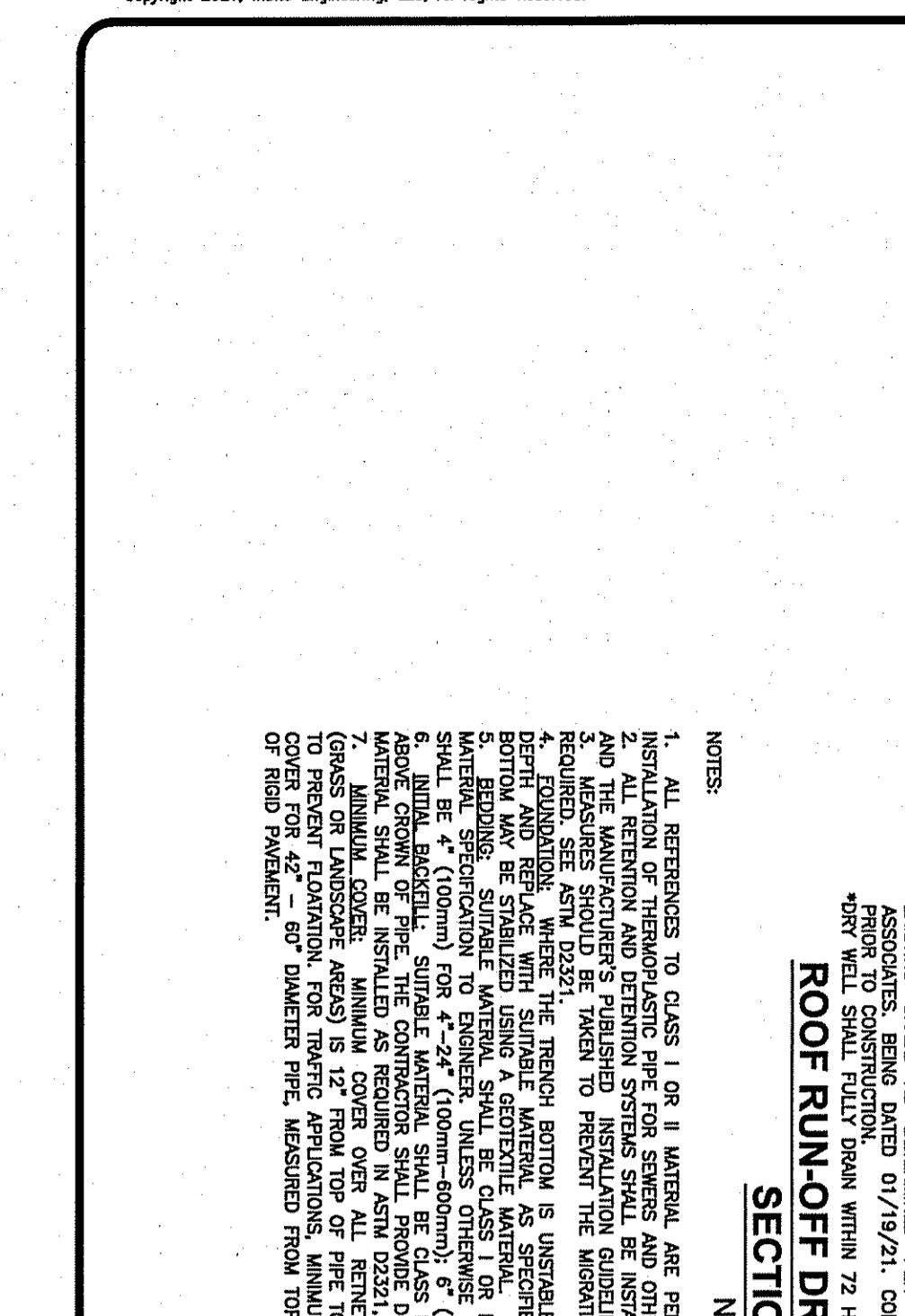
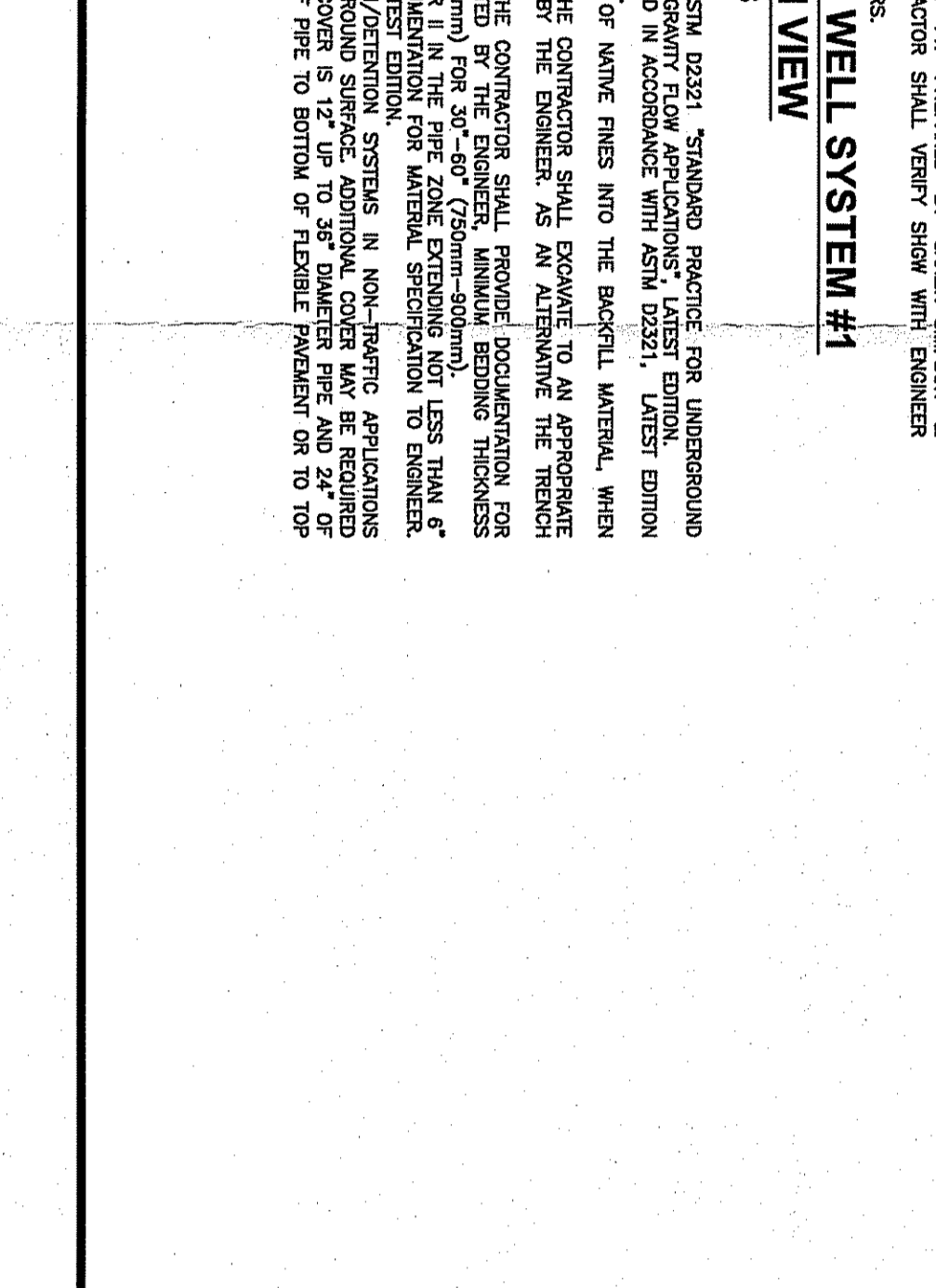
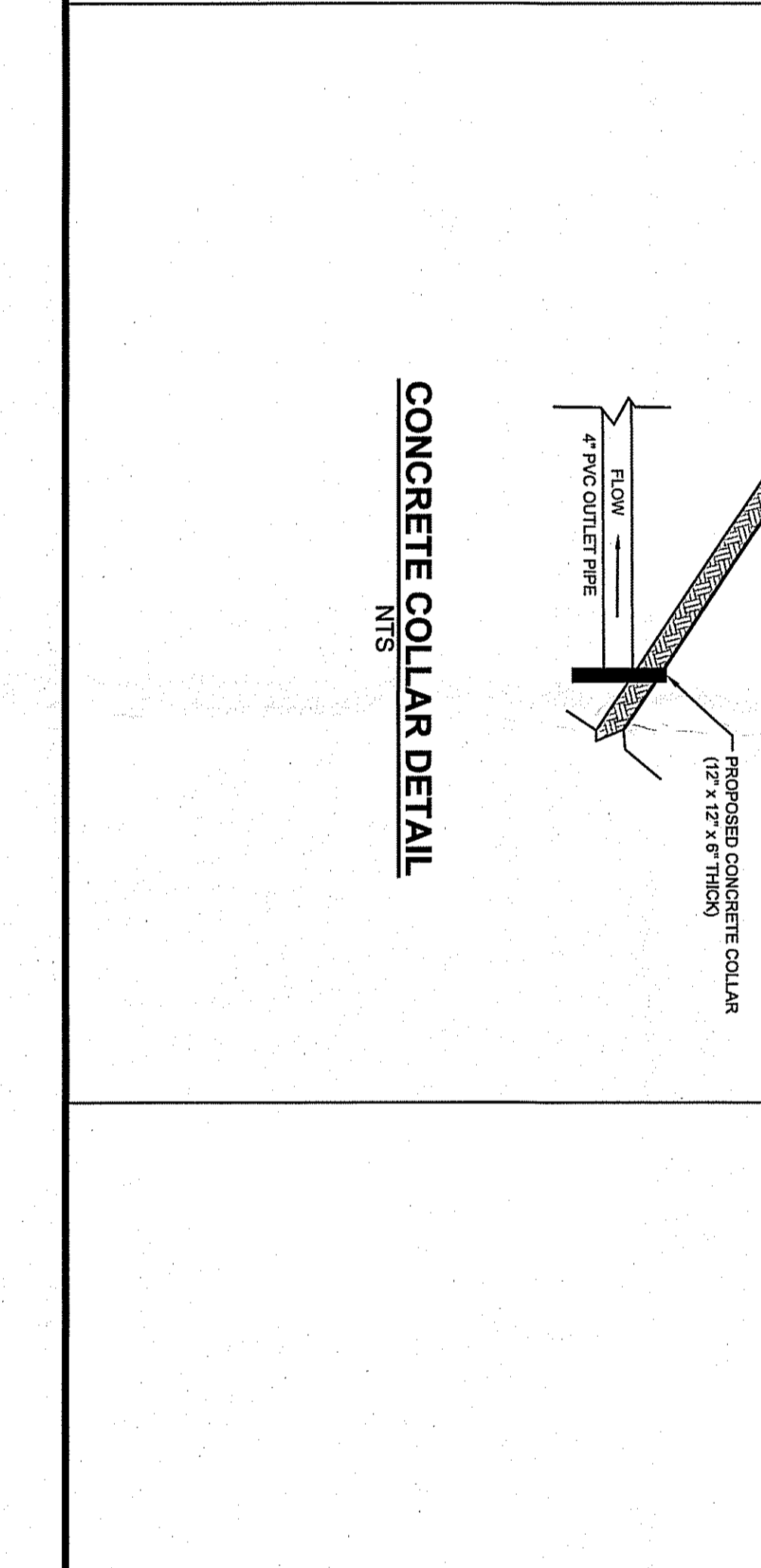
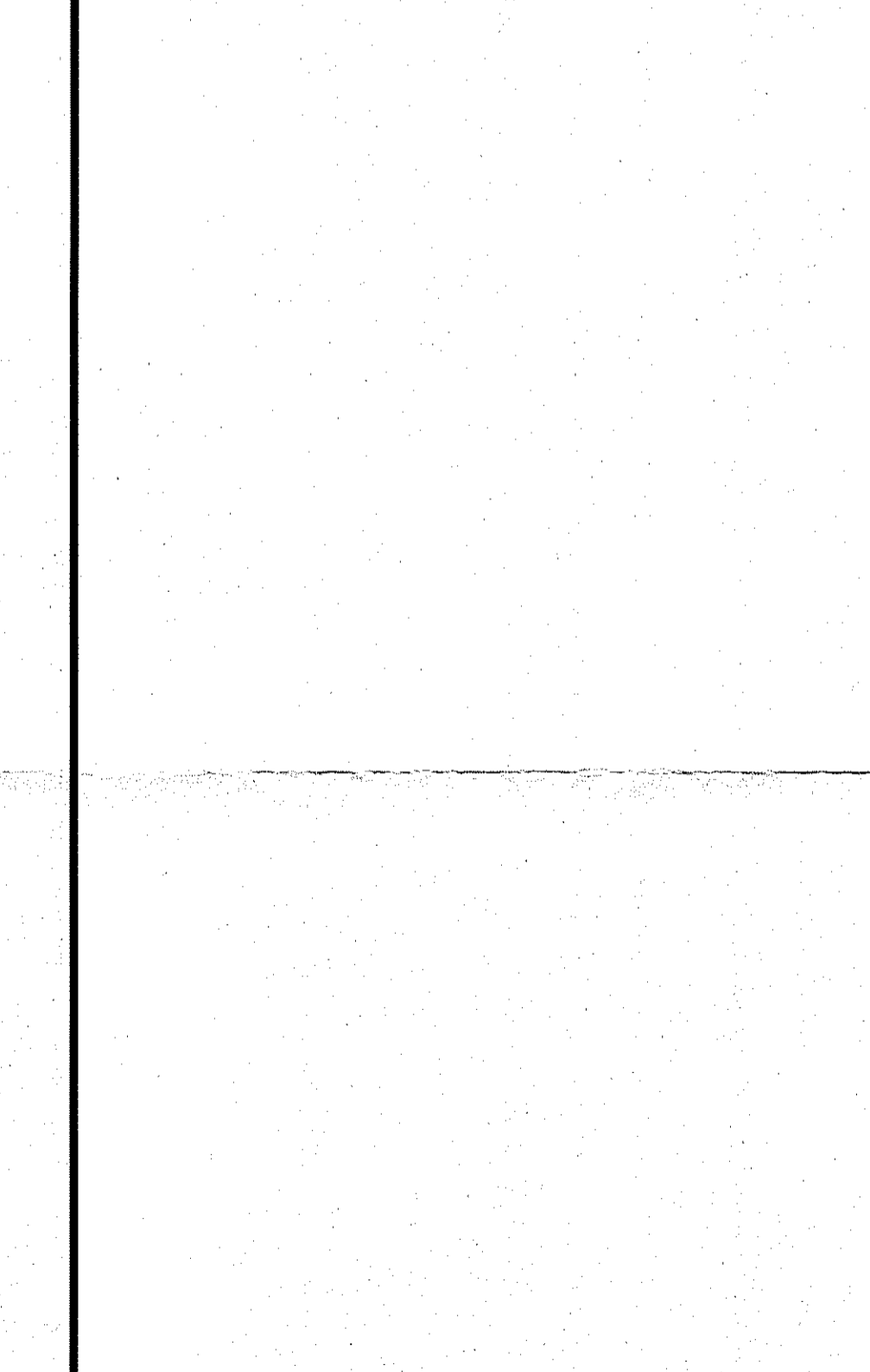
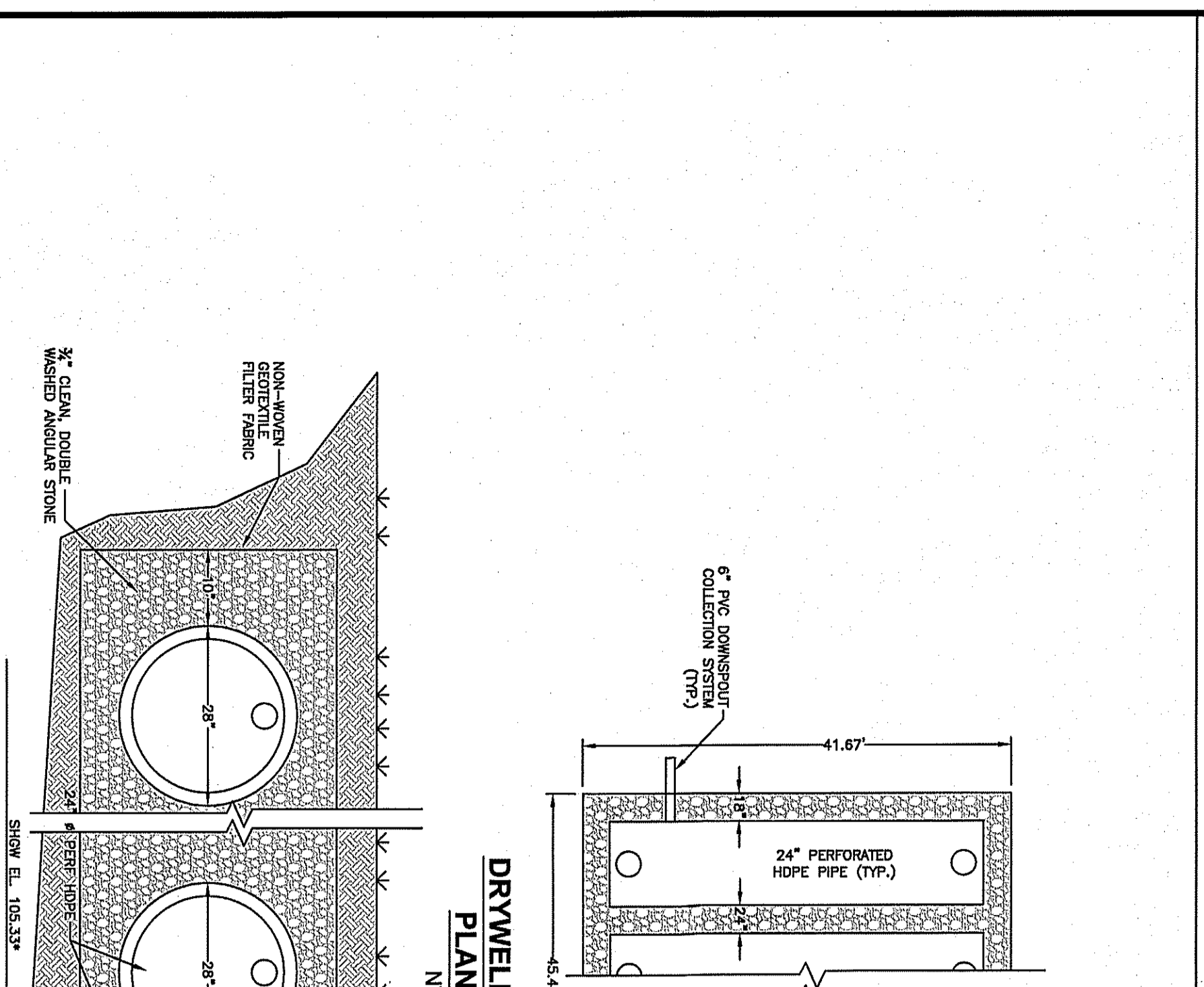
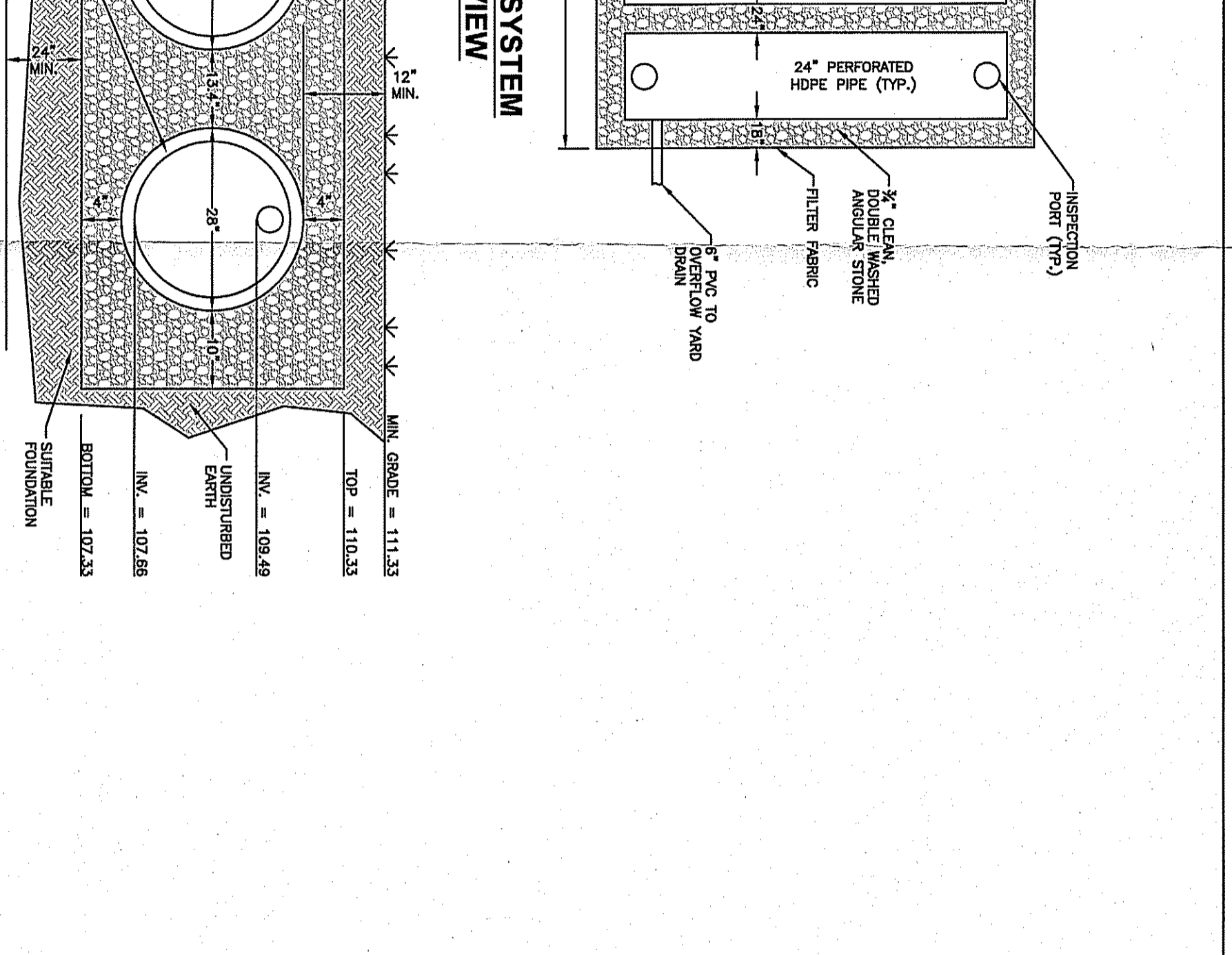
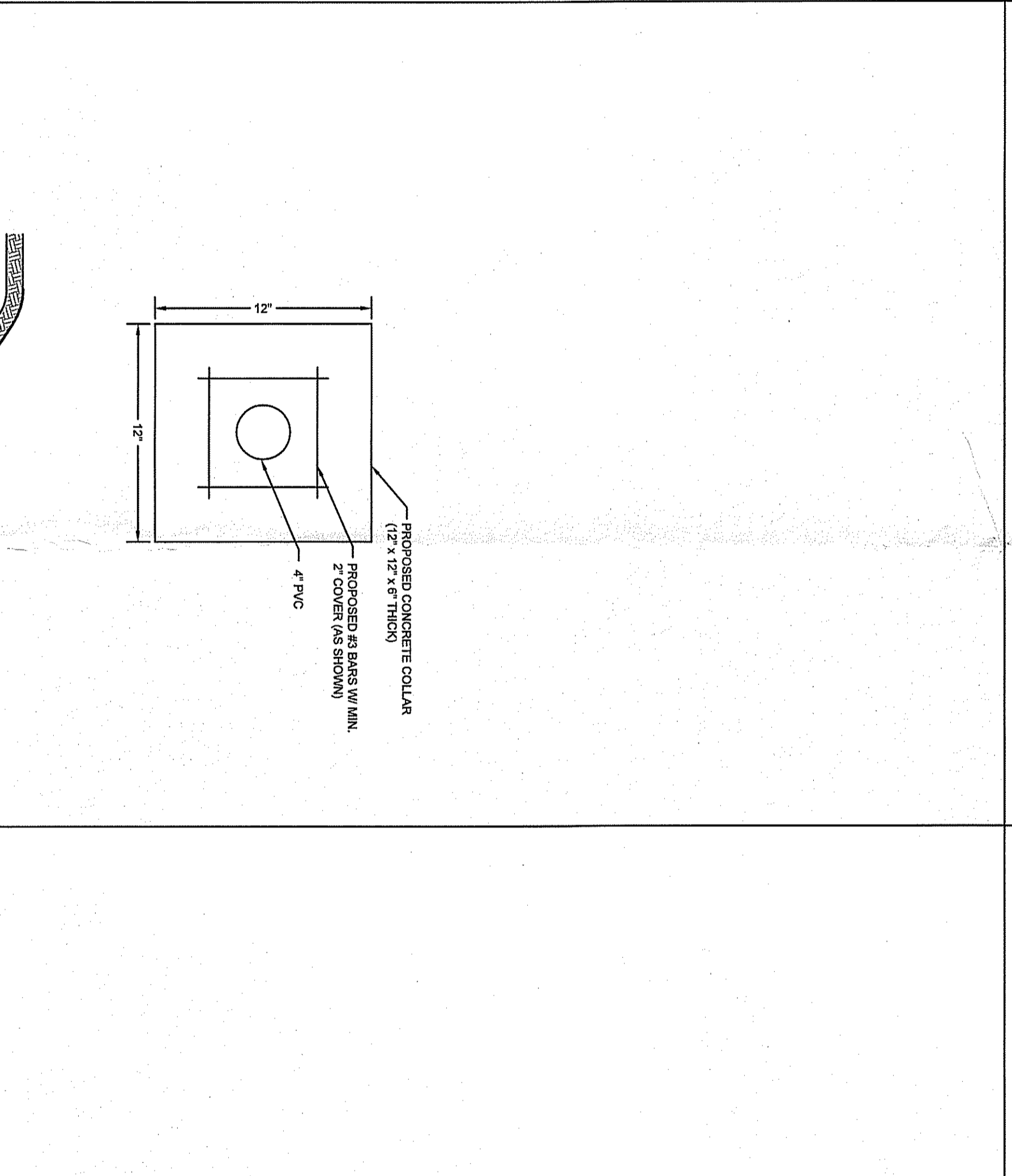
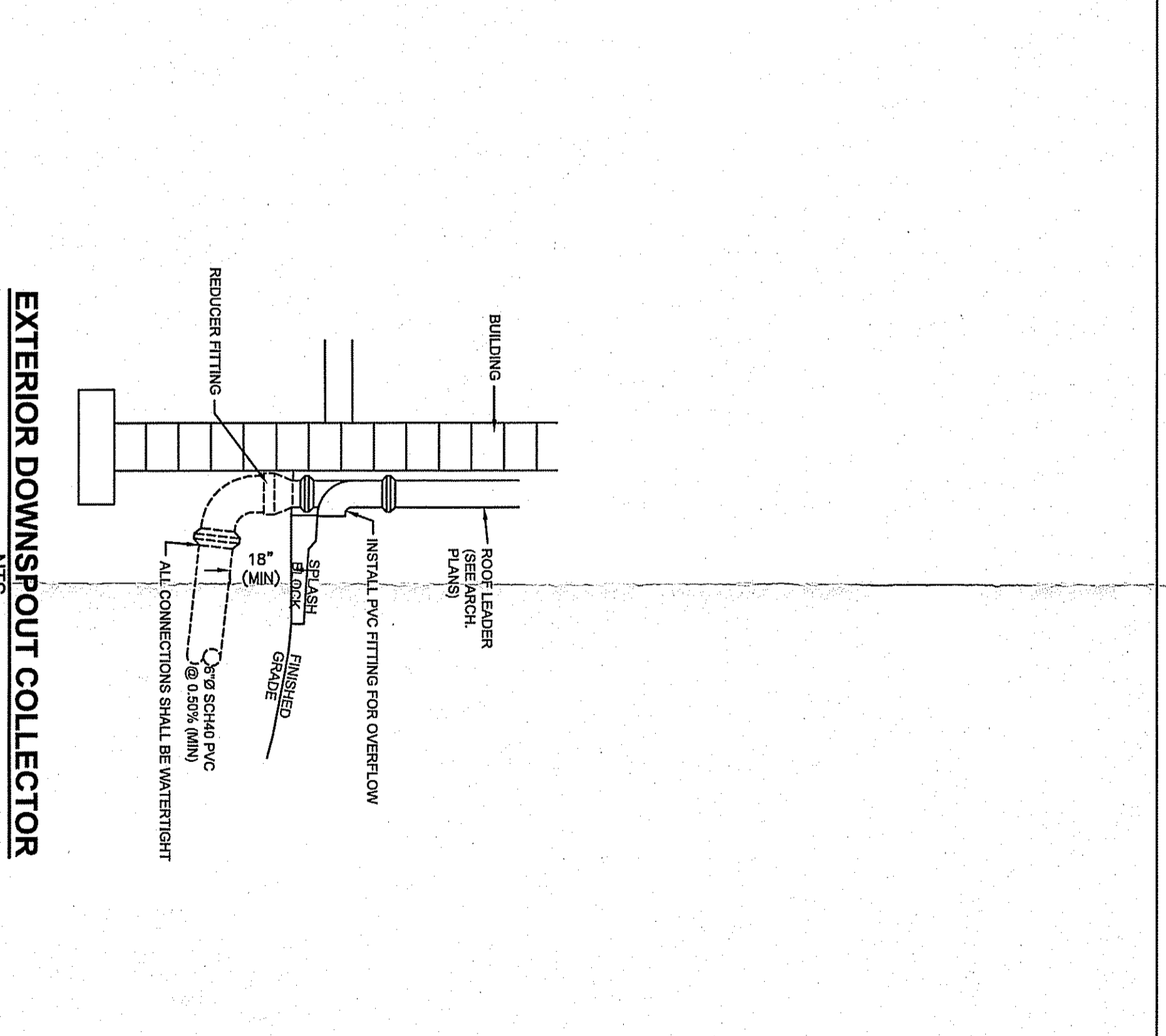
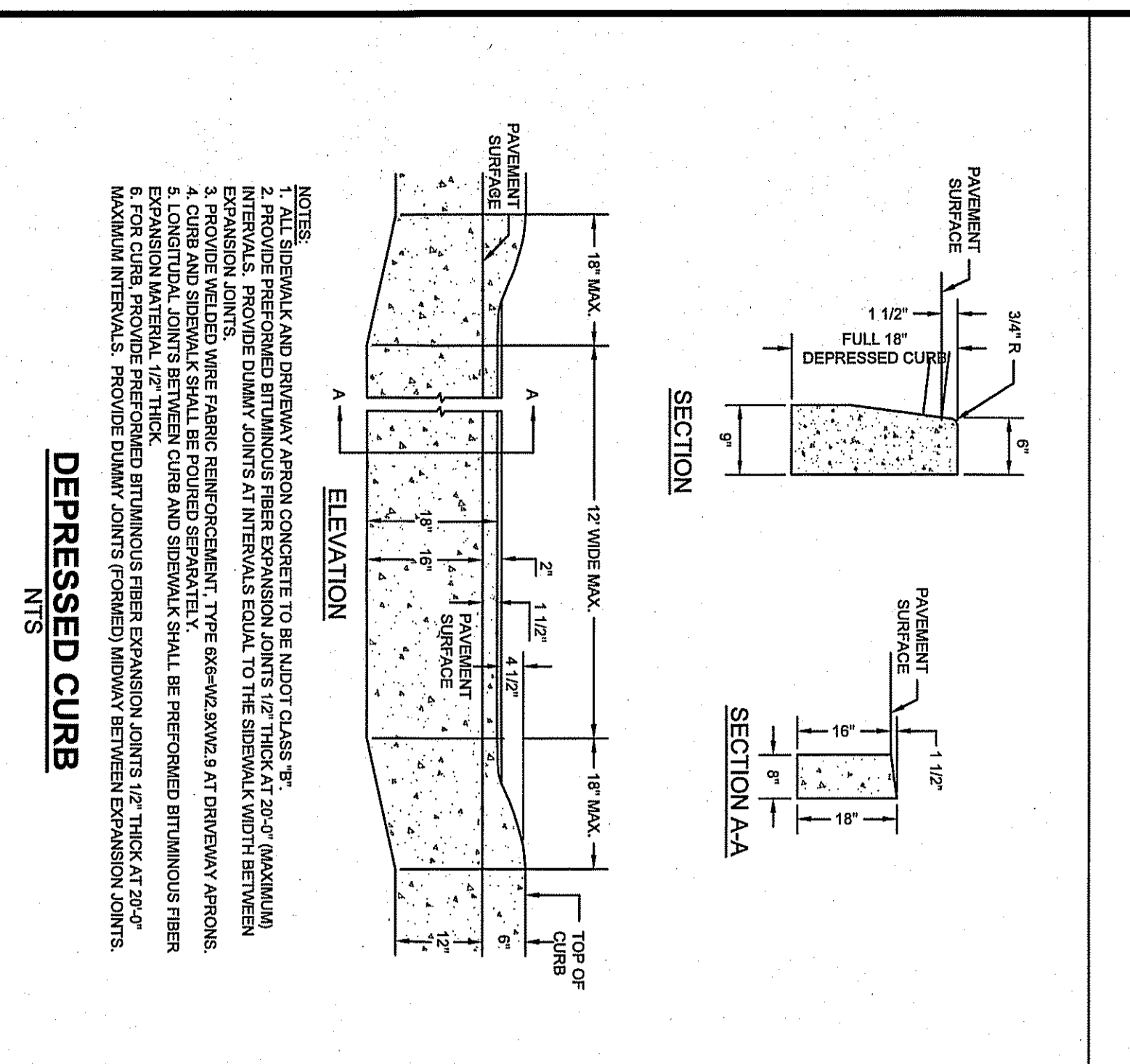
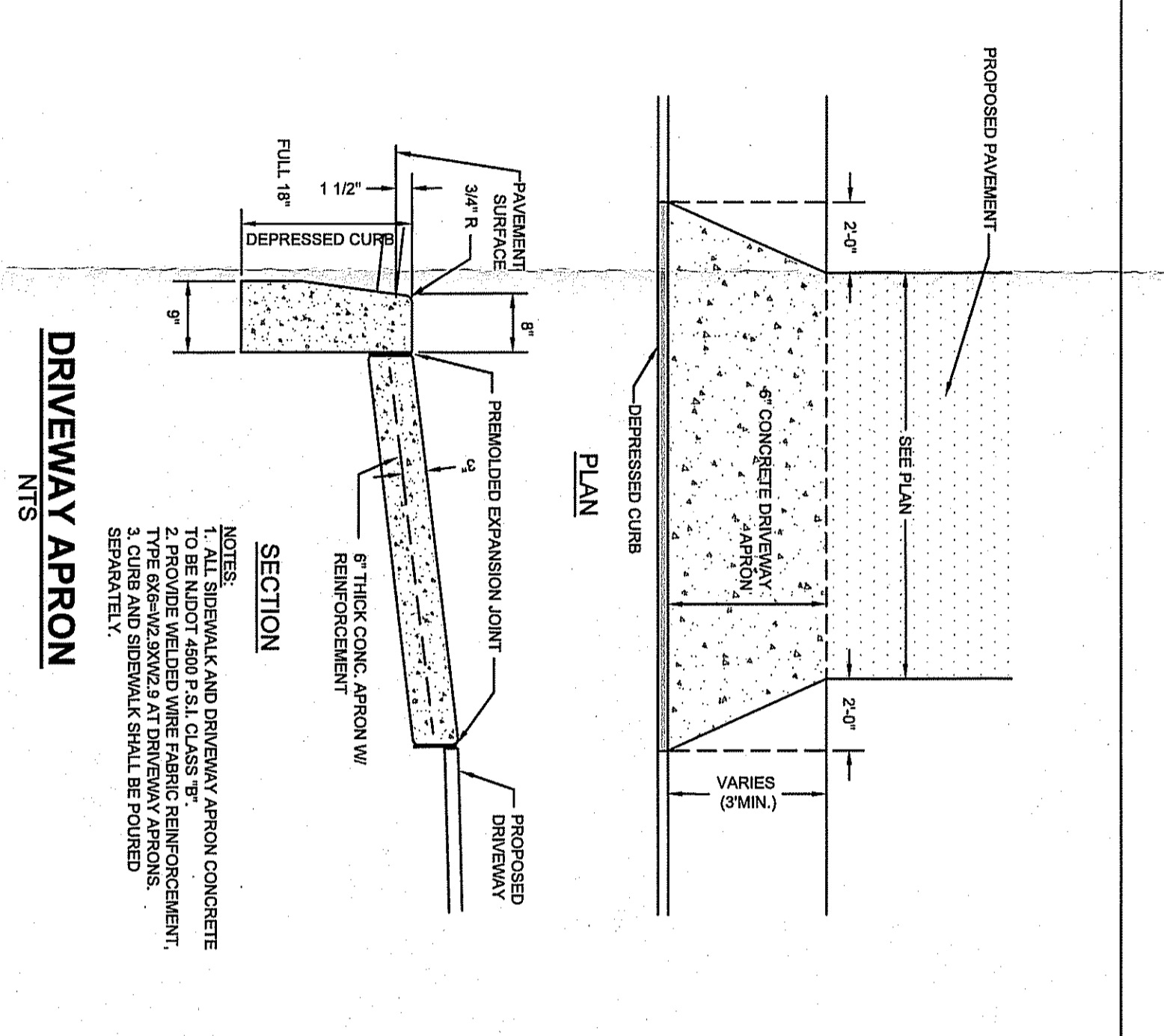
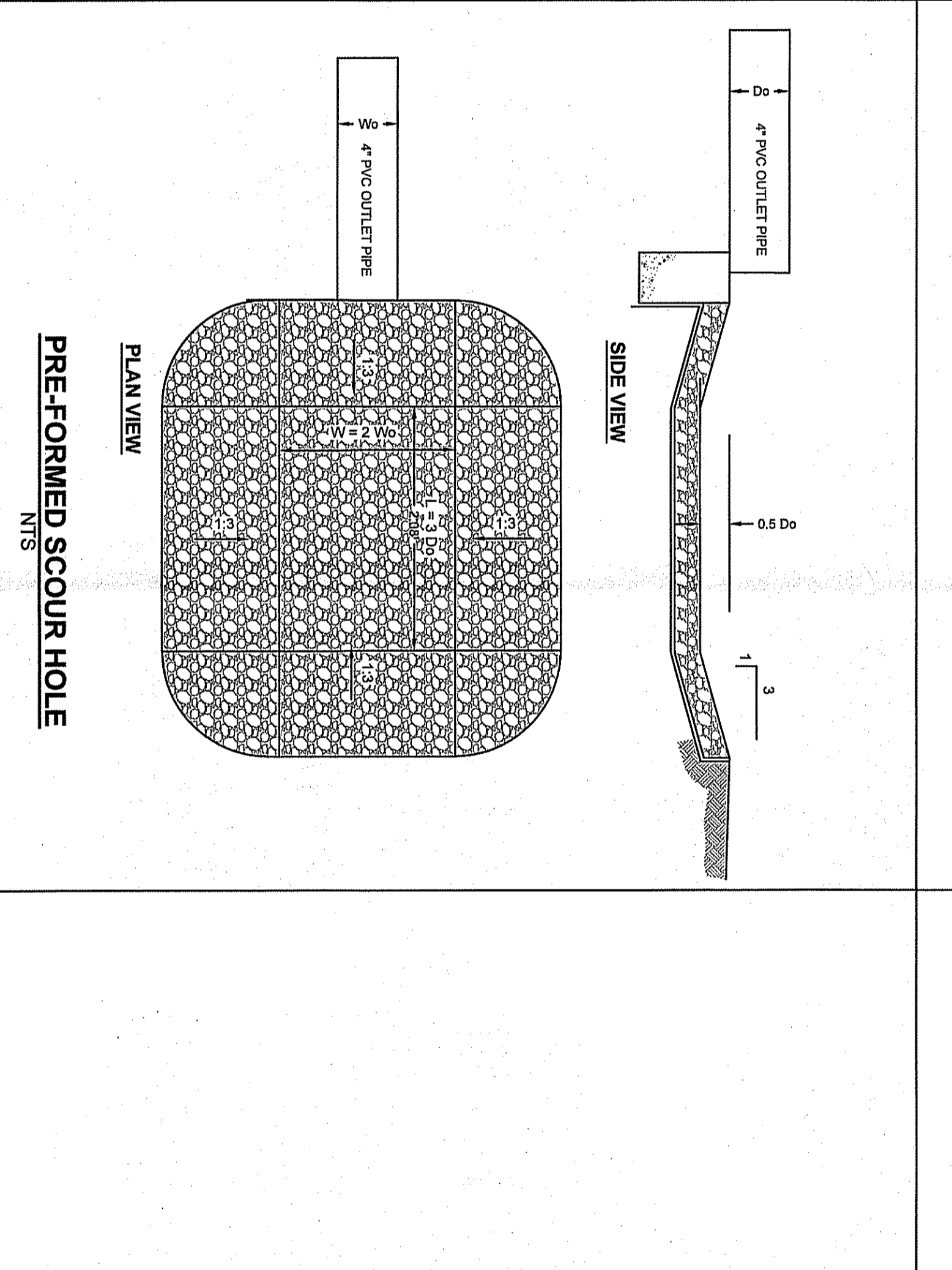
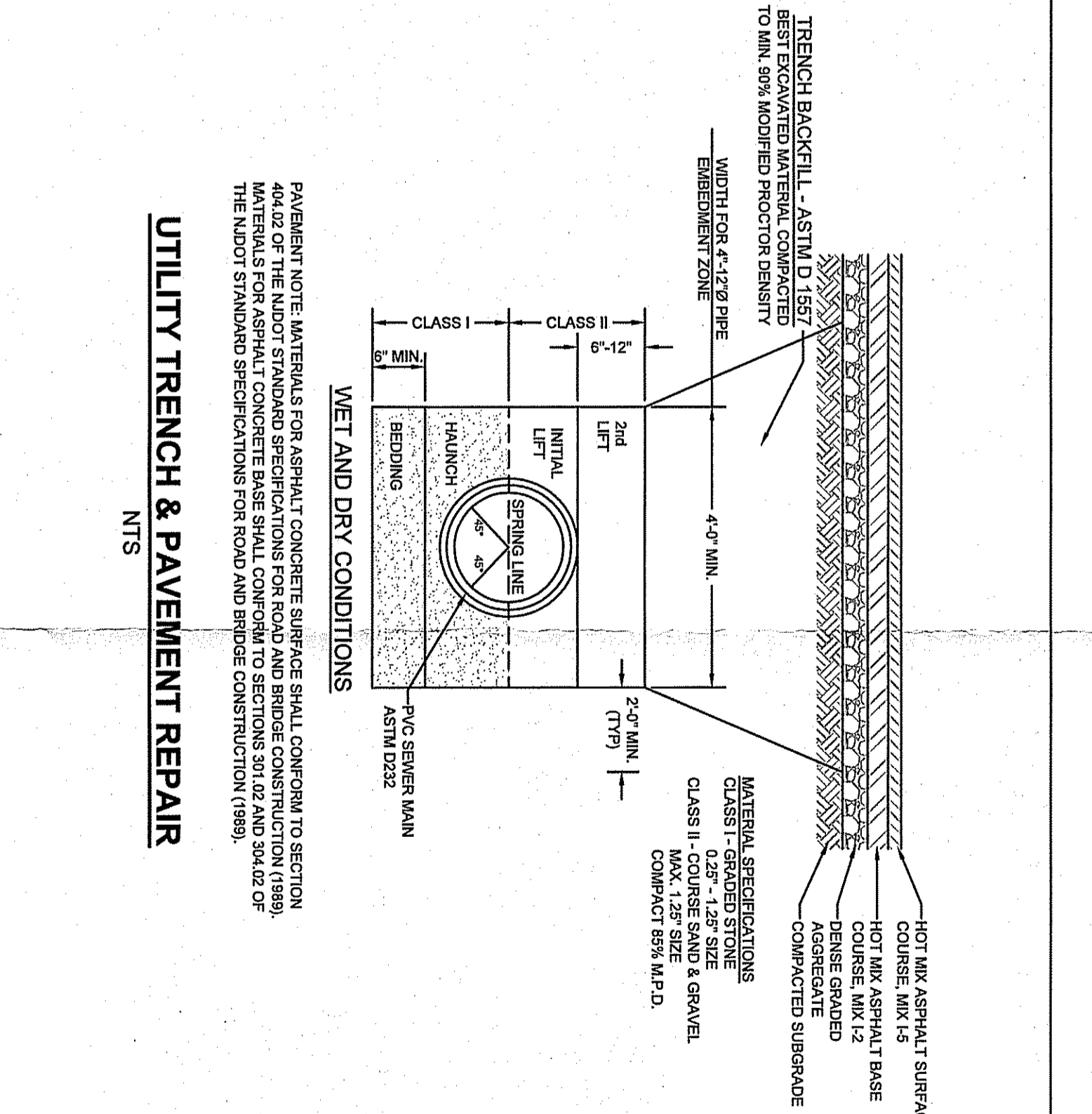
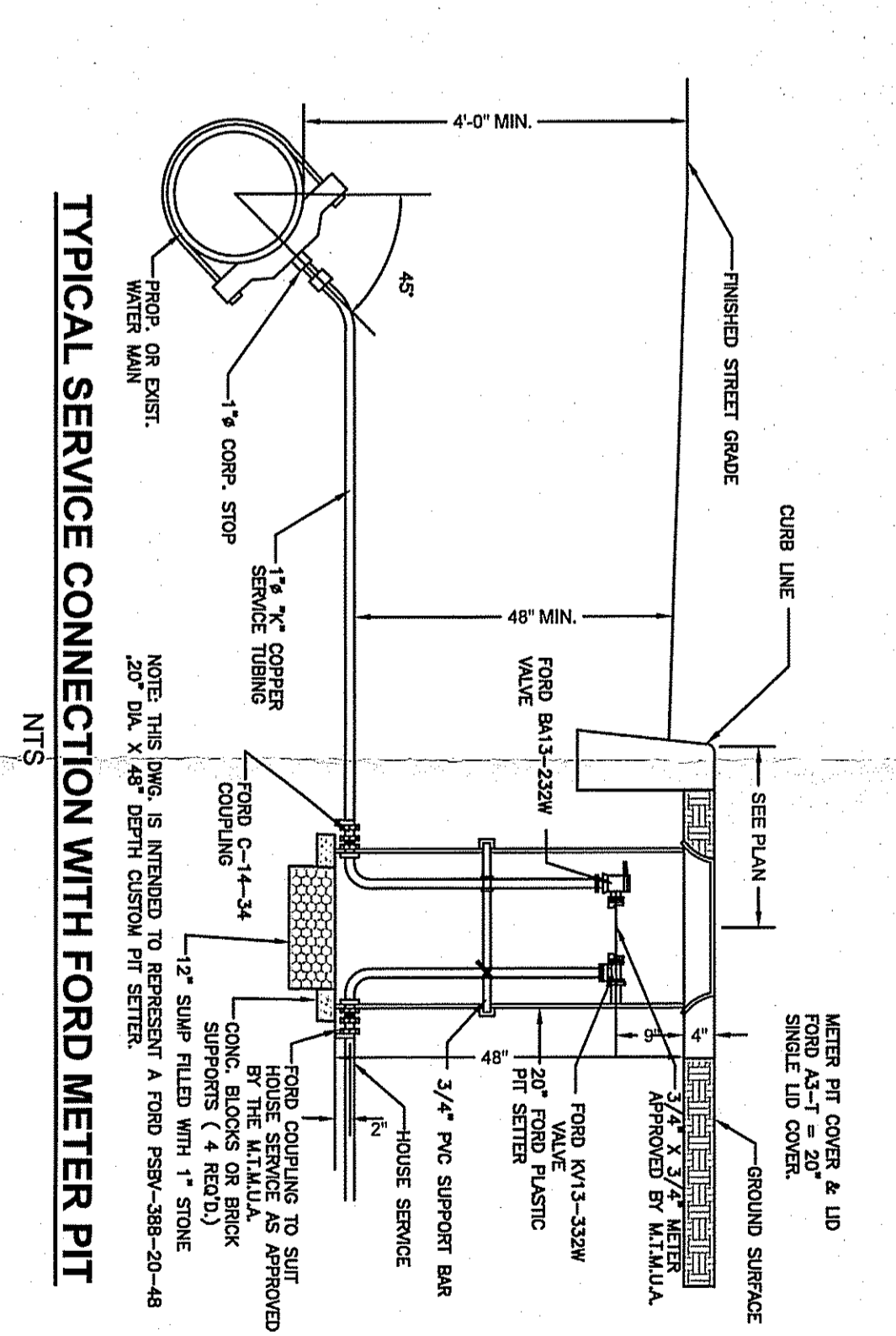

NO.	DATE	REVISIONS
1	08/22/20	ISSUE FOR PERMIT
2	08/22/20	ISSUE FOR CONSTRUCTION
3	08/22/20	ISSUE FOR CONSTRUCTION
4	08/22/20	ISSUE FOR CONSTRUCTION
5	08/22/20	ISSUE FOR CONSTRUCTION
6	08/22/20	ISSUE FOR CONSTRUCTION
7	08/22/20	ISSUE FOR CONSTRUCTION
8	08/22/20	ISSUE FOR CONSTRUCTION
9	08/22/20	ISSUE FOR CONSTRUCTION
10	08/22/20	ISSUE FOR CONSTRUCTION
11	08/22/20	ISSUE FOR CONSTRUCTION
12	08/22/20	ISSUE FOR CONSTRUCTION
13	08/22/20	ISSUE FOR CONSTRUCTION
14	08/22/20	ISSUE FOR CONSTRUCTION
15	08/22/20	ISSUE FOR CONSTRUCTION
16	08/22/20	ISSUE FOR CONSTRUCTION
17	08/22/20	ISSUE FOR CONSTRUCTION
18	08/22/20	ISSUE FOR CONSTRUCTION
19	08/22/20	ISSUE FOR CONSTRUCTION
20	08/22/20	ISSUE FOR CONSTRUCTION

**NOTES:**

1. ALL DIMENSIONS TO FACE UNLESS NOTED OTHERWISE.
2. ALL DIMENSIONS AND DETAIL NOTES SHALL BE IN ACCORDANCE WITH AIA 0221, LATEST EDITION.
3. MATERIALS SHALL BE INSTALLED IN ACCORDANCE WITH AIA 0221, LATEST EDITION.
4. MATERIALS SHALL BE INSTALLED IN ACCORDANCE WITH AIA 0221, LATEST EDITION.
5. MATERIALS SHALL BE INSTALLED IN ACCORDANCE WITH AIA 0221, LATEST EDITION.
6. MATERIALS SHALL BE INSTALLED IN ACCORDANCE WITH AIA 0221, LATEST EDITION.
7. MATERIALS SHALL BE INSTALLED IN ACCORDANCE WITH AIA 0221, LATEST EDITION.
8. MATERIALS SHALL BE INSTALLED IN ACCORDANCE WITH AIA 0221, LATEST EDITION.
9. MATERIALS SHALL BE INSTALLED IN ACCORDANCE WITH AIA 0221, LATEST EDITION.
10. MATERIALS SHALL BE INSTALLED IN ACCORDANCE WITH AIA 0221, LATEST EDITION.
11. MATERIALS SHALL BE INSTALLED IN ACCORDANCE WITH AIA 0221, LATEST EDITION.
12. MATERIALS SHALL BE INSTALLED IN ACCORDANCE WITH AIA 0221, LATEST EDITION.
13. MATERIALS SHALL BE INSTALLED IN ACCORDANCE WITH AIA 0221, LATEST EDITION.
14. MATERIALS SHALL BE INSTALLED IN ACCORDANCE WITH AIA 0221, LATEST EDITION.
15. MATERIALS SHALL BE INSTALLED IN ACCORDANCE WITH AIA 0221, LATEST EDITION.
16. MATERIALS SHALL BE INSTALLED IN ACCORDANCE WITH AIA 0221, LATEST EDITION.
17. MATERIALS SHALL BE INSTALLED IN ACCORDANCE WITH AIA 0221, LATEST EDITION.
18. MATERIALS SHALL BE INSTALLED IN ACCORDANCE WITH AIA 0221, LATEST EDITION.
19. MATERIALS SHALL BE INSTALLED IN ACCORDANCE WITH AIA 0221, LATEST EDITION.
20. MATERIALS SHALL BE INSTALLED IN ACCORDANCE WITH AIA 0221, LATEST EDITION.